

NEW REINFORCED CONCRETE RAMP,
GRADE 30 / 19 (3m WIDE, 0.15m THK)
WITH MESH REF 617 (T & B)

NEW WELDED MESH DOUBLE
LEAF GATE (2m WIDE CLEAR
OPENING) WITH 75mm SH
TUBULAR GATE POSTS AND
FRAMES CAST INTO RC FLOOR
AND ROOF. MESH VERTICAL
APERTURE: 76mm x 25mm - SEE
NOTES 4,5 & 6

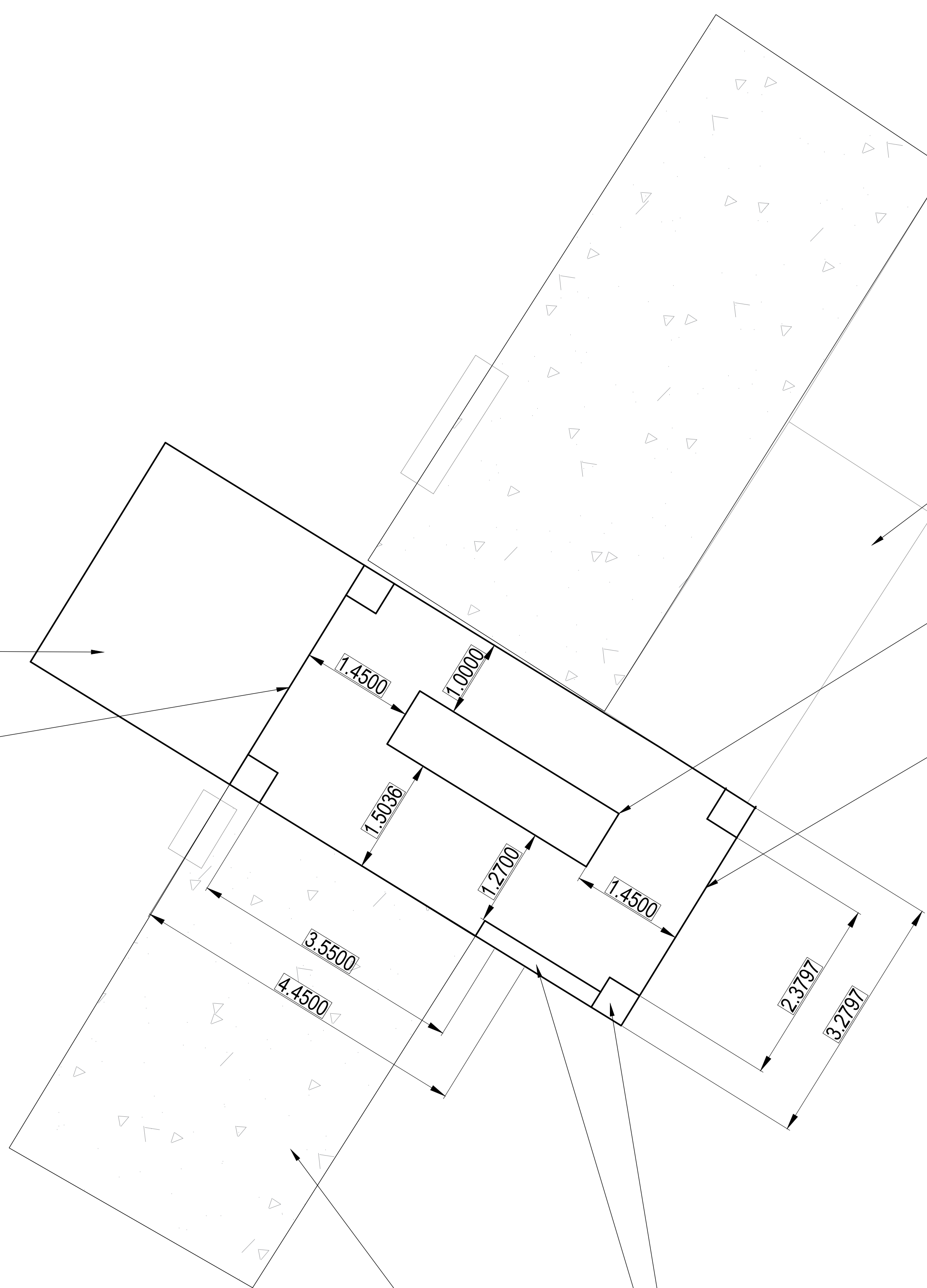

DESTROYED STORE ROOM (TO BE RE-BUILT BUT RE-LOCATED
TO SIDE OF CHLORINATION BUILDING). REFER TO STRUCTURAL
ENGINEER'S DRAWING 10909001-0509

NEW REPLACEMENT 400 KVA TRANSFORMER (BASE:
2800mm x 800mm). REFER TO ELECTRICAL ENGINEER'S
DRAWING FOR DETAIL

NEW MEDIUM-SECURITY WELDED MESH WITH CORNER
AND CENTER POST. MESH TO BE SECURED TO NEW
REINFORCED CONCRETE FLOOR AS PER CONTRACTOR'S
WORKSHOP DRAWINGS (TO BE APPROVED BY CIVIL
ENGINEER). SEE NOTES 4,5 & 6

NEW GMS FENCE POST CAST INTO CONCRETE FLOOR

NEW WELDED MESH FENCE, SEE NOTES
4,5 & 6

EXISTING OPERATOR'S OFFICE & WELFARE FACILITY
(TO BE REFURBISHED)

EXISTING MCC PLANT ROOM (TO BE REFURBISHED)

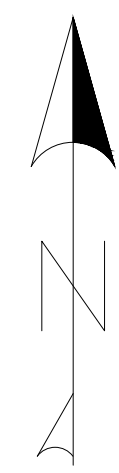

ISSUE FOR TENDER

- NOTES:
- LAYOUT PLAN PRODUCED ON THE BASIS OF PROFESSIONAL LAND SURVEYORS AS-BUILT SURVEY, APRIL 2022 (ANDON SURVEYS PTY LTD).
 - ALL EXISTING BUILDINGS TO BE REFURBISHED AS INDICATED ON CIVIL & STRUCTURAL DRAWINGS SHOWN ELSEWHERE.
 - DRAWING TO BE READ WITH SITE LAYOUT DRAWING 1090001-0104 FOR REFURBISHMENT OPTION A PLUS.
 - TRANSFORMER AREA TO BE SECURED WITH MEDIUM SECURITY WELDED MESH (CLEAR-VU / VISTA - DRAMENBERG GATE & FENCE OR SIMILAR APPROVED), FENCE SPECIFICATION:
 - VERTICAL APERTURE: 76mm x 25mm
 - FENCE HEIGHT: 2.4m
 - ALL WIRES TO BE GALVANISED & PLASTIC COATED
 - ALL FENCE POSTS (2m LONG) TO BE GALVANISED
 - ALL PANELS & GATE TO BE INSTALLED WITH SPINE RAILING AT TOP
 - ALL FASTENERS (BOLTS, WASHERS, NUTS): SS 304L
 - SPIKER CLAMPS OR SIMILAR: GMS WITH PLASTIC COAT OR SS 304L
 - GATE PADLOCK TO BE PROTECTED WITH WELDED GMS VANDAL PROOF PROTECTIVE COVER BOX
 - CONTRACTOR TO PROVIDE GUARANTEE ON FENCE WORKMANSHIP (MIN 1 YEAR, BUT 10 YEARS PREFERRED)
 - CONTRACTOR TO PRODUCE WORKSHOP DRAWINGS AND SUBMIT TO ENGINEER FOR APPROVAL PRIOR TO MANUFACTURING. CONTRACTOR TO CONFIRM DIMENSIONS ON SITE.

LEGEND:

LOCAL MUNICIPALITY: MAP



SPONSOR & REGULATOR: DWS



ISSUE FOR TENDER

0 100
100 MILLIMETRES ON ORIGINAL DRAWING

(A) BEFORE CONTRACT COMMENCES
(A) AFTER CONSTRUCTION CONTRACT HAS COMMENCED

Nr. DATE AMENDMENTS

(T1) 2025-05-17 ISSUE FOR TENDER

COPYRIGHT IS VESTED IN V3 CONSULTING ENGINEERS
IN TERMS OF THE COPYRIGHT ACT (ACT 95 OF 1978)

CLIENT / IMPLEMENTING AGENT



V3 CONSULTING
ENGINEERS

T: +27 51 045 1950
Suite 31, Nobel House, 190 Nelson Mandela Road,
Brentford, Brackenford, 5201

CESA

PROJECT
TSHAME WWTW REFURBISHMENT
VCWB CONTRACT: BW298/TSHIWWTW/22

DRAWING DESCRIPTION
GENERAL LAYOUT: REPLACEMENT
TRANSFORMER WITH BUILDING ENCLOSURE

DRAWING NO.
10909001 - 0575

REVISION

T1

DESIGNED: GM CHECKED: GM
DRAWN: BM SCALE: 1:100 AO
APPROVED: ECEA PRK ENG No: 2017024 INCEPTION DATE: 2024-07-09
FILE PATH: WWTW / G2 CONCEPT / 04 DRAW